

FOR VEHICLE USE ONLY



VEHICLEDOCK

OWNER'S MANUAL

Please read before using this equipment



Package Contents:
VEHICLEDOCK
Cable for Pod (2m)
Power Cable (0.5m)
IR Remote Eye with 3.5mm Jack (4.5m)
IR Remote Control
Owner's Manual

Inputs/Outputs

Left/Right Audio: analog audio output

Video: composite video output

S-Video: separated analog video output

Power Input: 11-15volts/dc

USB-A: standard universal serial bus, USB 2.0
(only to be used for firmware updates)

Remote Control

Battery: 3V, type CR2032 or equivalent

Video Format

NTSC/PAL (software switchable)

Note: Due to continuous product improvement, specifications are subject to change without notice.

My NAV TV VEHICLEDOCK isn't working, what's wrong?

First, be sure that your NAV TV VEHICLEDOCK is powered on. Next, make sure that you are in the desired mode - **On-Screen Navigation Mode** or **iPod Mode**. To change modes, simply push the **Mode Button** on your Remote Control. See Remote Control Functions [page 11]

My Music or Video sounds a little distorted and fuzzy, what's wrong?

Adjust Volume for the best sound quality.

If your iPod's Music through your NAV TV VEHICLEDOCK sounds unusually low or noisy, be sure that your NAV TV VEHICLEDOCK's volume is set at an adequate level. The balance of volume between your NAV TV VEHICLEDOCK and output equipment can affect the audio quality significantly.

Introduction	04
iPod Compatibility	05
Connection Diagrams	07
Remote Control	10
My Jukebox	13
Viewing Photos on Screen	14
Album Art	16
<hr/>	
Settings:	
Colour Schemes	18
Language Settings	18
Screen Saver Settings	19
Switching Video Formats	20
Tips and Trouble Shooting	21
Technical Specifications	23

With an available A/V input in your mobile multimedia system, this product allows use of your iPod to:

- Play your music
- Playback video
- Display pictures in a slideshow

You will have full control of your iPod via:

- Infrared Remote Control
- Via the iPod itself
- Via the OEM screen (with an optional vehicle interface)

You can use the VEHICLEDOCK with:

- Any factory system with a matching vehicle input (optional)
- A mobile multimedia system
- Any rear-seat entertainment system with A/V input.

This versatile add-on solution lets you connect your iPod to a monitor in your car and enjoy all your iPod entertainment, including movies! The VEHICLEDOCK not only brings your current system up-to-date for watching movies, it gives you a sophisticated user interface that works similar to iPod, with the same convenience and ease of use. Listen to your iPod music on your car system, watch iPod videos, even listen to audio books and podcasts. It's the perfect solution for bringing the iPod into an existing mobile multimedia system.

I've selected a photo slideshow to play on my screen, but it's only playing on my iPod screen.

On your iPod, check to see that your **TV Out** setting under Video/Slideshow Settings is set to either **Ask** or **On**. Your Video or Slideshow will not play on your screen unless you select **TV On** when prompted by your iPod in the **Ask** setting, or you have selected **On** under **TV Out** in Video Settings. Your iPod arrives in the **Ask** setting, so you will have to select **TV On** each time you start up a Video or Photo Slideshow unless you change your iPod Settings. Remember, iPod nano does not support external photo slideshows. For more information see the **NOTE** on [page 14].

The NAV TV VEHICLEDOCK sometimes seems to have a small delay before it displays my iPod's content like Album Art or song information. Why?

The response delay time, if any, is usually the NAV TV VEHICLEDOCK waiting for information from the iPod. Hard-drive based iPods like the 5G iPod with video take longer than flash based iPods like the iPod nano. How long it takes depends on how much content is on the iPod and what information is being requested. For instance, when you've selected a screen saver on the NAV TV VEHICLEDOCK that displays "large" Album Art 200 x 200 pixels, (if available), it can take up to 20 seconds for the iPod to access that art work. See **Things to Understand About iPod Album Art** [page 17] for more information.

Switching Between NTSC and PAL

The NAV TV VEHICLEDOCK default broadcast format is NTSC. However, it is PAL compatible too. If you have a screen that is configured for PAL and your iPod's video format is set for PAL, simply select the PAL setting in NAV TV VEHICLEDOCK **Settings**.

We recommend that you set your iPod and VEHICLEDOCK to NTSC video format for best picture quality if your screen is capable of displaying it.

To switch between NTSC and PAL settings, follow the steps below:

NTSC to PAL

1. Be sure you are on the Main Menu Screen

NOTE: Your iPod must be removed from the NAV TV VEHICLEDOCK before attempting to change formats.

2. Press the **Left Arrow Button** (◀) once, then the **Down Arrow Button** (▼) once, then repeat. This will switch your video output from NTSC to PAL.

PAL to NTSC

1. Be sure you are on the Main Menu Screen

NOTE: Your iPod must be removed from the NAV TV VEHICLEDOCK before attempting to change formats.

2. Press the **Left Arrow Button** (◀) once, then the **Up Arrow Button** (▲) once, then repeat. This will switch your video output from PAL to NTSC.

iPod Models Supported

MUSIC COMPATIBILITY:

All Dockable iPods (excluding 3G iPod)



iPod touch
2nd generation
8GB 16GB 32GB



iPod nano
4th generation (video)
8GB 16GB



iPod classic
120GB



iPod touch
1st generation
8GB 16GB 32GB



iPod nano
3rd generation (video)
4GB 8GB



iPod nano
2nd generation (aluminum)
2GB 4GB 8GB



iPod classic
80GB 160GB



iPod
5th generation (video)
30GB 60GB 80GB



iPod nano
1st generation
1GB 2GB 4GB



iPod
4th generation (color display)
20GB 30GB 40GB 60GB



iPod
4th generation
20GB 40GB



iPod mini
4GB 6GB

PICTURE COMPATIBILITY:

iPod nano
4th generation (video)
8GB 16GB



iPod nano
3rd generation (video)
4GB 8GB



iPod classic
80GB 160GB



iPod
5th generation (video)
30GB 60GB 80GB



iPod
4th generation (color display)
20GB 30GB 40GB 60GB

VIDEO COMPATIBILITY:

iPod nano
4th generation (video)
8GB 16GB



iPod nano
3rd generation (video)
4GB 8GB



iPod classic
80GB 160GB



iPod
5th generation (video)
30GB 60GB 80GB

The NAV TV VEHICLEDOCK has several different Screen Savers to choose from. They are great for customising your iPod experience as well as preventing screen burn on certain in-car screens. Selected Screen Savers include:

Now Playing

Displays Album Art (if available) and track progress as well as song information.

Album Art

Displays Album Art (if available) that repositions every few seconds.

Status Bar

Displays a simplified version of the Main Status Bar.

Black Screen

Displays small info with Album Art (if available) on bottom left of screen for a moment, then fades to black.

Various Visualisations

Displays visualisation patterns that are co-ordinated with current musical selection.

Screen Saver Time

10 secs, 2 mins, 5 mins, 10 mins, or never.

Screen Savers on the NAV TV VEHICLEDOCK can be set up to come on at different intervals, or never. Just select the desired timing for your Screen Saver under **Settings/Screen Saver Time**. TIP: You may also start up a Screen Saver at any time by simply pressing the Screen Saver Button on your remote control (page 11).

Settings

Connection Diagram

Colour Schemes

Aftermarket Screen

The NAV TV VEHICLEDOCK has 12 amazing colour schemes that lets you customise your iPod viewing experience. You can match your NAV TV VEHICLEDOCK interface to your iPod, your car interior or your mood. Just go to Settings/Colour Schemes and select the right one for you.

Languages

The NAV TV VEHICLEDOCK has 9 different languages. Select yours from the NAV TV VEHICLEDOCK Settings/Languages.

Available Languages:

English, Spanish, French, German
Italian, Dutch, Japanese, Russian, Swedish.

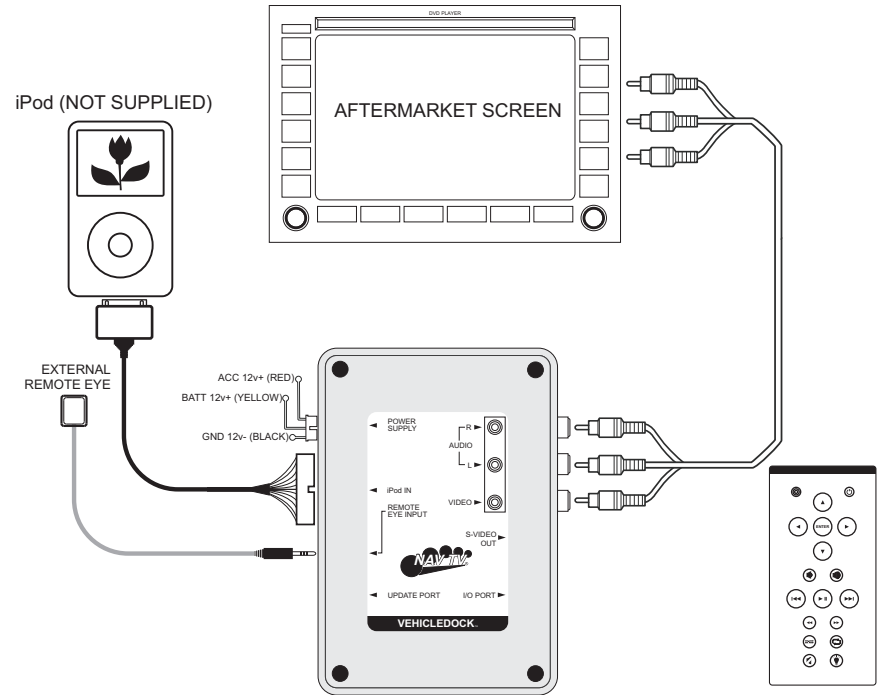

OPV Kit (optional extra) is a programmable device designed to provide an A/V input allowing control of your iPod (or any after-market device) via the factory screen or buttons on the head unit without having to use the remote control. It also allows you to view and use your screen whilst your car is in motion

iPod (NOT SUPPLIED)

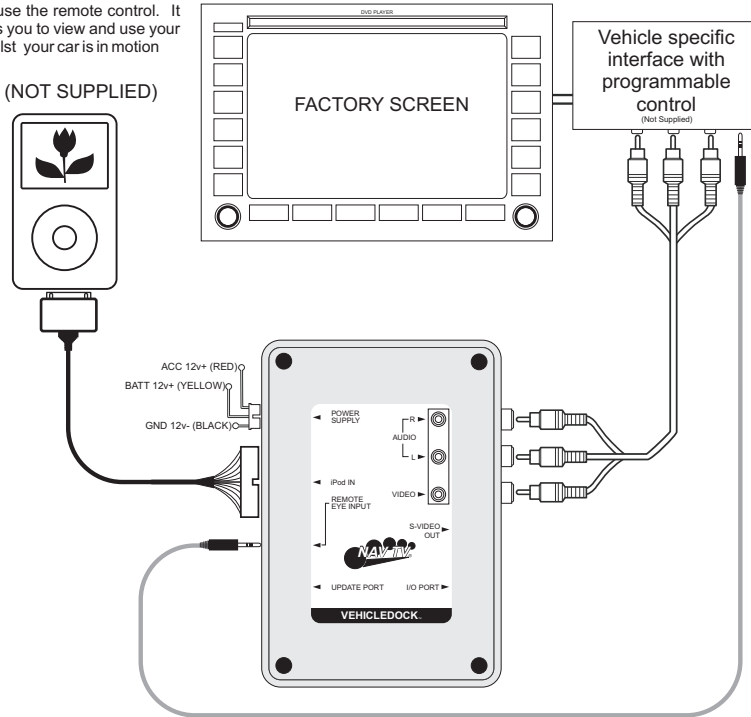

The maximum size of Album Art available is 200 x 200 pixels from iPods with Video. For the iPod nano, the maximum Album Art size is 100 x 100 pixels. It can take several seconds to load artwork from your iPod. While the larger 200 x 200 pixel artwork is loading, the NAV TV VEHICLEDOCK will display smaller Album Art.

NOTE: You will see a **Please Wait** message if you attempt to use the remote while your iPod is delivering Album Art to the NAV TV VEHICLEDOCK.

If your current selection does not have any Album Art, or if the Album Art is unavailable, the NAV TV VEHICLEDOCK will display the icon below instead of Album Art.

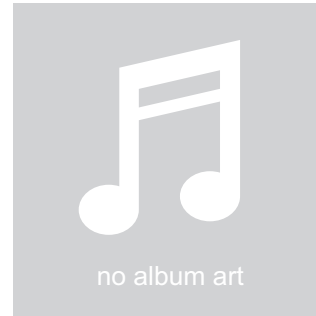

NOTE: 4th Generation colour iPods (iPod Photo) do not support external display of Album Art.

*if available

The NAV TV VEHICLEDOCK will display your iPod Album Art (if available) for the track currently playing on your screen. You can view your Album Art in several different ways:



Whenever a selection is playing the NAV TV VEHICLEDOCK displays the Album Art in the left corner of the status bar. Sometimes Album Art may take a moment to load.

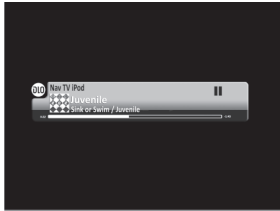

Several screens like **Now Playing**, **Album Art** and **Status Bar**, feature Album Art. The NAV TV VEHICLEDOCK will automatically update the Album Art when the next track begins playing.

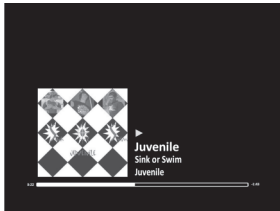

Select **Now Playing** from the NAV TV VEHICLEDOCK's Main Menu to display Album Art and song information.



*if available

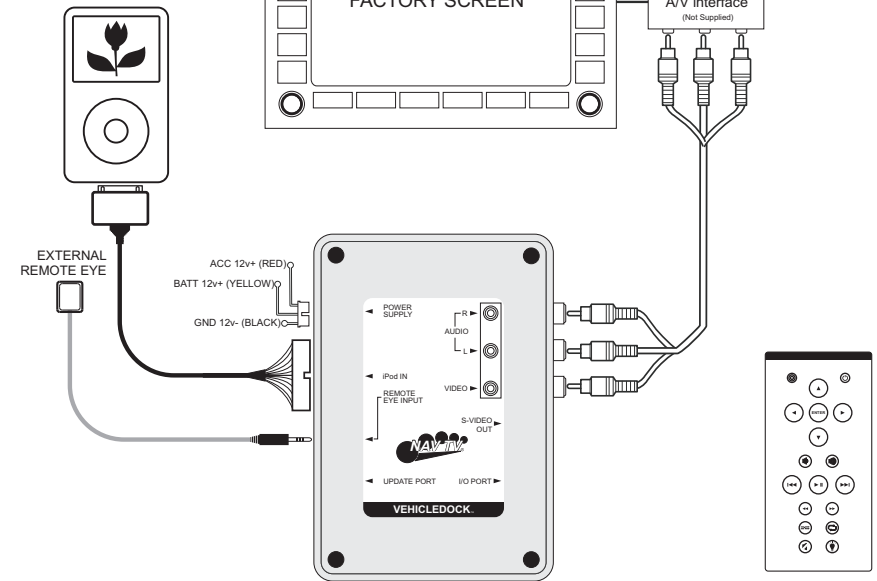

interfaces dedicated to your car's sat nav screen are available from NAV TV, check the website. www.nav.tv

iPod (NOT SUPPLIED)



Use **On-Screen Navigation Mode** to control and display your iPod's Music and Videos, including Playlists, TV Shows, Rentals, Movies, Albums, Artists, Songs, Genres, Podcasts, etc.

1. Select **Music** or **Videos** from the Main Menu Screen.
2. Select the category of Music or Video you would like to view: **Playlists, Movies, TV Shows, Artists, Albums, Songs, Podcasts**, etc.
3. Scroll up or down to select the particular Song or Video you would like to play. Then with the Song highlighted, press the **Enter Button**  or press the **Right Nav Arrow Button** 

To return to the main menu during Video playback, press the **Enter Button**  on the remote control. To return to the main menu from Audio playback keep pressing the **Left Nav Arrow Button**  on the remote control until you return to the main menu.

From the Main Menu Screen, you can also go immediately to your iPod's Playlists and choose a track to listen to. You can even choose **Shuffle Songs** to play songs randomly from your library.

Any time a track is playing from your iPod using the NAV TV VEHICLEDOCK, the current track info is displayed at the top of your screen with Album Art (if available). The NAV TV VEHICLEDOCK also displays a track countdown timer, the track progress bar, the name of your iPod, as well as Album and Playlist information (if applicable).

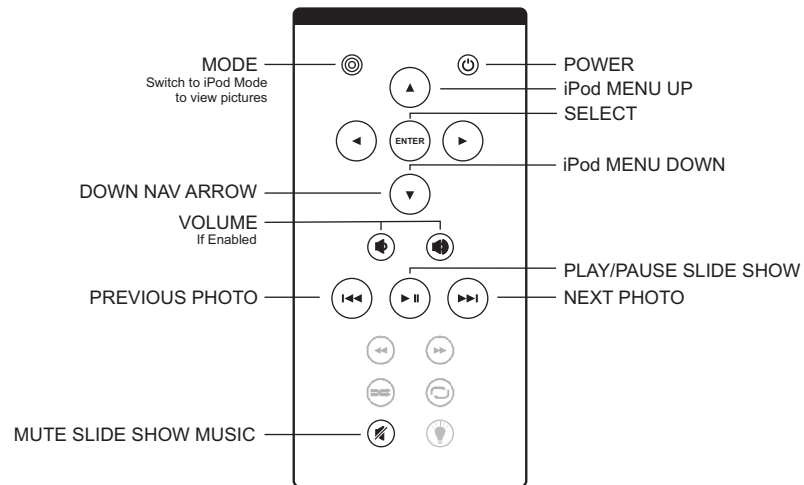

To view pictures from your photo-compatible iPod, follow these easy steps:

1. Connect your iPod. Switch the VEHICLEDOCK to iPod Mode (**MODE** button, top left on the remote control).

2. Navigate, select and play a Slideshow from your iPod using the VEHICLEDOCK remote control or the iPod controls.

NOTE: Be sure to select **On** under **TV Out** within Slideshow Settings on your iPod menu. You can use the Remote Control's Nav Arrow Buttons to make your selections.

3. Once you have selected a slideshow from your library, start it with the Play Button
NOTE: Enter/ Select will display the picturers on the iPod only.

4. Control functions such as Play/Pause, Next Slide, Previous Slide from the comfort of your seat with the NAV TV VEHICLEDOCK Remote Control. Refer to the Remote illustration to learn how to direct your photo slide shows using the NAV TV VEHICLEDOCK Remote Control.

5. When you have finished watching your slideshows, be sure to switch back from iPod mode by pressing the **MODE** button again.

NOTE: Unfortunately, the iPod nano (1st and 2nd Generation) iPod Touch and iPhone do not currently support external playback of its **internal photos**. However, all music functions, including On Screen Navigation, are fully functional.

If you have any questions or need help setting up your iPod for Photos and Slide shows, please visit Apple Support at:

www.apple.com/support/ipod.

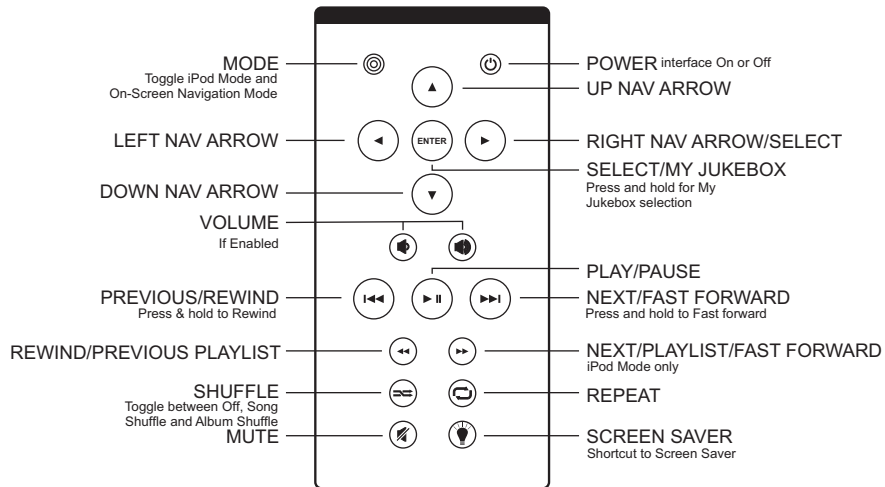

The VEHICLEDOCK lets you enjoy your iPod music through your in-car multimedia system as well as playing your iPod movies through your in-car screen.

You can either select your Music or Videos directly from your iPod (**iPod Mode**) when not wishing to use the remote control, or switch to **On-Screen Navigation Mode** to view, navigate and select your Music or Videos using VEHICLEDOCK's sleek **On-Screen Navigation**.

To switch between On-Screen Navigation and iPod Mode, use the Mode button on the remote control. In iPod Mode, Videos and Photos will be sent to your screen, provided the TV Output on the iPod is enabled.

Refer to the remote control illustration for more information about the VEHICLEDOCK's Remote Control.

The VEHICLEDOCK gives you the option of creating your own Playlists from your iPod directly on your in-car screen. You can select these on-the-fly Playlists using the **My Jukebox** feature on the Main Menu Screen. Here's how:

1. Whilst any song is playing, press and hold the **Enter Button**  on your Remote Control .
2. When the Highlight Bar blinks, the song selection has been copied to the My Jukebox Playlist on the Main Menu Screen.
3. After you have selected as many items as you want for you're my Jukebox Playlist, you may navigate back to the Main Menu Screen to play selections from My Jukebox.
4. To clear you're my Jukebox Playlist, simply select **Clear List** and hold.

NOTE: My Jukebox will not save a Playlist after an iPod is disconnected or if the VEHICLEDOCK is powered off.