

NAV-TV

INTERFACING THE FUTURE

3950 NW 120th Ave, Coral Springs, FL 33065
TEL 561-955-9770 FAX 561-955-9760

SECURE-A-KEY



Passive Keyless Entry (PKE) vehicle theft protection
NTV-KIT934,935,936,937



Overview

SECURE-A-KEY is an anti-theft device specifically designed for preventing relay-style frequency amplification attacks. The most common way high-tech thieves steal PKE-equipped cars is by using a device to capture frequency of the vehicle’s key-fob, then transmit the data to a co-conspirator near the vehicle for unlocking and starting the car. Secure-A-Key installs inside your vehicle’s Keyless-GO remote and electronically disconnects the battery from the fob after 5 minutes of non-movement. This significantly reduces the typical range of the key until the it is again in motion.

Kit Content / SKU Variants

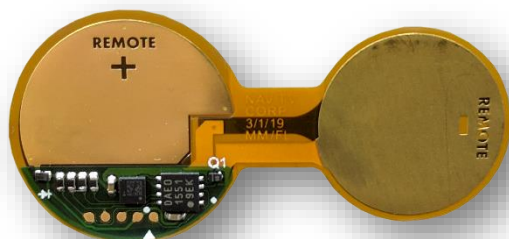

(2x) SECURE-A-KEY [2032]: NTV-KIT934
(1x) SECURE-A-KEY [2032]: NTV-KIT935

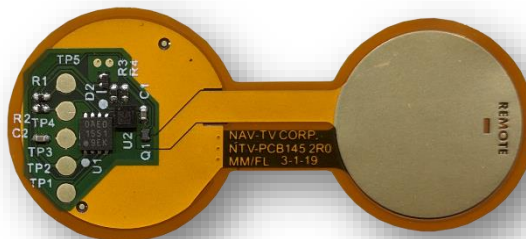

(2x) SECURE-A-KEY [2450]: NTV-KIT936
(1x) SECURE-A-KEY [2450]: NTV-KIT937

SECURE-A-KEY installation

Installing the SECURE-A-KEY is easy. It requires prying open the remote just as if you were to replace the button battery. The flexible PCB wraps around the battery with the circuitry facing UP *towards you* (positive side) – replace the battery into the remote carefully, replace the cover properly and installation is complete. TEST all remote functionality after installation.

Refer to the owner’s manual of the vehicle to access the button battery of the remote if you’re having trouble.

SECURE-A-KEY Operational Notes

- SECURE-A-KEY works by effectively removing battery power to the remote (which reduces the typical range) after ~5 minutes of inactivity.
- SECURE-A-KEY is programmed to be sensitive enough to recognize common vehicle systems checks while driving.
- SECURE-A-KEY will shorten the battery’s life span *slightly*, as it must constantly wait for inactivity of the remote – a small price to pay for peace of mind!
- SECURE-A-KEY [2032] includes a 2025 battery. **Replace your size 2032 battery with the 2025 *only if the added bulk of the SECURE-A-KEY is too tall to fit properly in the remote (with the cover).***

1

2

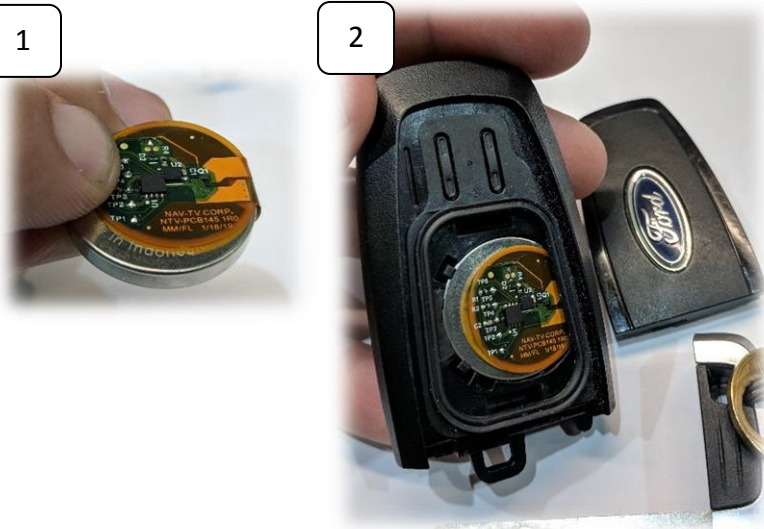

Key-Fob known battery sizes

NOTE: For SAK2032, you may be required to swap to a battery equivalent with a thinner profile to fit Secure-A-Key. Do NOT force the SECURE-A-KEY into the remote case if it doesn't fit easily.

Auto Manufacturer	OEM Battery Type	Compatible Secure-A-Key
Nissan	2025,2032	2032
AUDI/Lamborghini	2016,2025	2032
Chrysler/Maserati/Fiat	2032	2032
Chrysler Type 2	2032	2032
Chrysler Type 3 (Jeep)	2032	2032
Ford/Lincoln	2032	2032
Ford F150/F250/Mustang	2450	2450
BMW/Mini	2032	2032
BMW Type 2	2450	2450
Land Rover Type 1	2032	2032
Land Rover Type 2	2032	2032
Mercedes	2032	2032
GM/Chevy Smart	2032	2032
Cadillac	2032	2032
RAM Truck	2032	2032
Buick/Chevy	2032	2032
Acura	2032	2032
Honda Elite Smart	2032	2032
Hyundai Genesis	2032	2032
Hyundai Smart (all)	2032	2032
KIA Smart (all)	2032	2032
Lexus Smart (all)	2032	2032
Mazda	2025	2032
Mitsubishi	2032	2032
Porsche	2032	2032
Ferrari	2032	2032